



Rack pass through dishwashers from Winterhalter

Best performance and great flexibility



GS 500 Series – Powerful and flexible

Winterhalter – The specialist for warewashing systems

- + A family company in its 3rd generation
- + Represented in more than 70 countries worldwide
- + At home in the largest and best washing kitchens
- + Professional dishwashing technology from under counter to flight-type dishwashing machines
- + Complete solutions consisting of machine, detergent products, water treatment and accessories – all from a single source

The GS 500 Series from Winterhalter provides the rack pass through dishwasher most suitable to your individual needs. The classic **GS 502 and GS 515 models are perfect** for restaurants, hotels or smaller kitchens. With the **Energy or Energy+ energy-saving versions**, you get the same washing capacity and an additional, innovative energy recovery system. And for **extreme capacity** fluctuations or a constantly larger throughput, there is the **GS 500 TwinSet Series**. As you can see: **performance and flexibility** are key in the GS 500 Series. Because results are what count – and with Winterhalter they are always brilliant!

With an **intelligent integrated concept** consisting of machine technology, detergent products, water treatment and accessories, Winterhalter delivers hygienically clean washing results. **Trust the specialist for professional warewashing systems.**





Plate for plate – Winterhalter rack pass through dishwashers push more through your washing kitchen.



GS 502 / GS 515 – High washing power, economical operation



The innovative irt economy models from Winterhalter reduce your consumption of important resources. They take it easy on the environment and your wallet.

Winterhalter GS 502 / GS 515 dishwashers leave nothing to chance. From their **100 % hygienic, double-skinned machine anatomy** and **systematic wash water filtration** to the outstanding washing power of their **collision wash jets** – these machines are made to deliver optimal cleaning results. And you can rely on Winterhalter to be economical as well. Because energy and water consumption are among the most important factors for deciding which commercial dishwasher to purchase, Winterhalter has developed **economy models with »intelligent resource technology« (irt)**. New processes reduce the consumption of resources such as electricity, water, detergent and rinse aid. They reduce your operating costs permanently.

Economy



Reduced rinse water volume

A newly developed rinse system saves real money during every wash cycle. This optimisation delivers a reduction in rinse water consumption from 3.2 to 2.4 litres* per wash cycle, thus reducing operating costs by more than 20 % per year.

Performance



High washing power

The GS 502's collision wash jets provide maximum washing power. The GS 515's XXL compact wash system with reversing wash arms and high performance jets guarantees the best cleaning results, even when faced with the toughest dirt.

Machine operation



Operating reliability

With its simple, self-explanatory Winterhalter single-button operation, the dishwasher has everything under control. The language-neutral colour coding prevents mistakes – a big advantage when the turnover of untrained personnel is high.



Work ergonomically

The ergonomic hood handles and optional automatic hood opener (GS 515) provide comfortable machine operation, even when workdays are long.

* All information under ideal conditions. Fresh water consumption is dependent on local conditions. Fine adjustments are made upon installation.



Hygiene concept



Smooth, seamless surfaces

The smooth, deep-drawn hygiene tank with rounded corners keeps dirt and deposits away. Lime scale and dirt don't have a chance due to the surface heating element. These features make cleaning simple.



Self-cleaning programme

When operation is finished, the interior self-cleans automatically and then the machine switches itself off. The integrated drain pump removes any remaining dirty water from the machine – deposits and odours are eliminated.



Quadruple wash water filtration

Large dirt particles are trapped by a total coverage filter system with a removable filter cassette. It can be easily removed without previously draining the water from the tank. The pump inlet filter provides additional reliability.

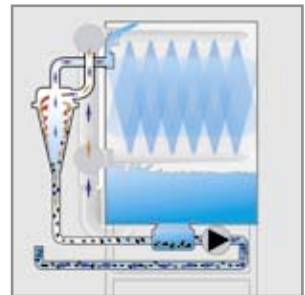

Mediamat wash water filtration keeps the finest dirt particles out of the detergent solution permanently – this significantly reduces detergent consumption.

Quadruple wash water filtration keeps the detergent solution so clean that it can be used for a whole workday – this permanently reduces water and energy consumption.



The GS 502 makes your dishes sparkling clean.

GS 502 – High performance under the hood

The GS 502 is the ideal machine for medium-sized companies in the catering sector. Its input height and total width have been specially designed to accommodate the dishes this sector uses. The **compact wash system with high performance collision wash jets** guarantees clean dishes – and short programme cycles as well. The detailed **Winterhalter hygiene concept** provides perfect cleanliness in the interior of the machine. With its **simple, language-neutral single-button operation**, the machine can be operated safely and correctly.

The GS 502 is compact and flexible despite its high capacity. You can rely on the performance of the GS 502 – in the straight version or the corner variant, depending on your space requirements.



GS 515 – The powerhouse in XXL format

With its impressive XXL washing area, the GS 515 enhances the proven GS 502 concept it is based on. With more width, now 735 mm, and an unrestricted input height of 440 mm, the XXL accommodates large dishes such as pizza plates and trays.

The GS 515 naturally goes all out when it comes to washing power. A **total coverage washing system with reversing wash arms** delivers concentrated power in all three programmes. Even the toughest dirt is washed away. Like the GS 502, the GS 515 is equipped with single-button operation.

And with the option of either a straight or corner variant, Winterhalter provides an XXL machine that is perfectly adapted to your washing kitchen.

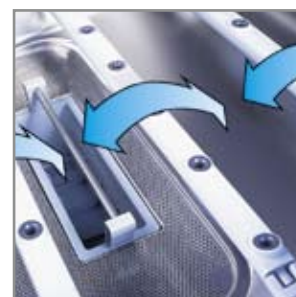

The reversing washing system adds more movement to your GS 515. Even the toughest dirt is »scraped« from your dishes – it doesn't have a chance.

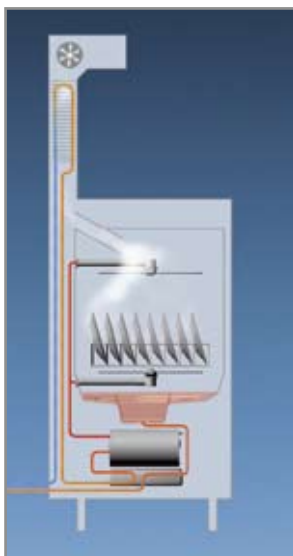

Schematic diagram of the heat recovery process in the GS 502 Energy⁺ (with cold water supply).

GS 500 Energy Series / GS 500 Energy⁺ Series – Full steam ahead for savings

Moist, warm water vapour escapes each time clean dishes are unloaded – valuable energy that disappears into thin air. **The GS 502 Energy / GS 515 Energy** transform it into real added value using an exhaust air heat exchanger. Because when the hood is closed the machine draws the moist, warm water vapour directly from the interior in advance, using its energy to heat the cold incoming water supply. **This lowers your energy costs by up to 5,250 Euro¹⁾ over eight years**, and permanently improves the room climate as well.

GS 502 Energy⁺ / GS 515 Energy⁺ are additionally equipped with a waste water heat exchanger and also use the energy from their waste water. **This increases your savings to up to 7,000 Euro²⁾ over eight years.**



The GS 501 programme switch

GS 501 – The basic model with all the necessary equipment

The GS 501 with a single-wall hood provides you with all the basic features that a rack pass through dishwasher should have. You also benefit from a consistent hygiene concept with deep-drawn tank, surface heating element and filter system. **Simple, correct operation** is guaranteed by the **Winterhalter programme switch**. **Practical hood handles** support a fast, effective workflow. The removable wash arms make it **easy to clean the machine**.

In addition to its perfected dishwashing technology, the GS 501 has high-power nozzles that provide evenly distributed, intensive cleaning and thus optimal cleanliness.



The GS 500 TwinSet Series – Twice the power, maximum flexibility

The GS 500 TwinSet was specifically designed for businesses that experience extreme capacity fluctuations together with peak utilisation levels. Two identical standard machines that are connected at the hood take care of large quantities of dishes and glasses with **double capacity at peak times**. As soon as the rush is over, the hoods can be **disconnected very easily with one motion**. You then continue washing with one machine. That avoids idle runs and saves water, detergent, and power.

Since each machine works for itself, **the dishes can be separated by type**, for example. This makes it possible **to coordinate** the temperature, detergent and water quality optimally.

The TwinSet provides a special plus for beer glasses: they can be hygienically washed hot, then rinsed cold without slowing down the washing process.



The TwinSet principle can be applied to all models in the GS 500 Series:

- GS 501
- GS 502
- GS 502 Energy
- GS 502 Energy⁺
- GS 515
- GS 515 Energy
- GS 515 Energy⁺



Technical data	GS 501	GS 502	GS 502 Energy / GS 502 Energy ⁺	GS 515	GS 515 Energy / GS 515 Energy ⁺
Theoretical capacity [racks/h]	30	60/30/15	60/30/15	70/30/15	70/30/15
Width [mm]	635	635	635	735	735
Depth [mm]	749	749	749	749	749
Height [mm]					
– Hood closed	1420	1469	2145	1530	2235
– Hood open/ total height	1886	1932	2145	2050	2235
Input height [mm]	420 ± 5	420 ± 5	420 ± 5	440	440
Rack dimensions [mm]	500 x 500	500 x 500	500 x 500	500 x 500 540 x 500 500 x 600	500 x 500 540 x 500 500 x 600
Rinse water consumption per wash cycle* [l]	3.2	2.4	2.4	2.4	2.4
Tank temperature [°C]	60	60	60	60	60
Boiler temperature [°C]	85	85	85	85	85
Total connected load [kW]					
– Hot water connection 40-60 °C	8.9	9.5	–	9.6	–
– Cold water connection Up to 20 °C	14.9	15.5	12.5/9.5	15.6	12.6/9.6

* Under ideal conditions. Fresh water consumption is dependent on local conditions. Fine adjustments are made upon installation.

Technical data	GS 501	GS 502	GS 515
AirCon 500			
Depth [mm]	749	749	749
Width [mm]	635	635	735
Machine height [mm]	1420	1469	1530
Total height [mm]	2295	2295	2390
– Control attached at side	2230	2230	2325

Technical data	GS 501	GS 502	GS 502 Energy / GS 502 Energy ⁺	GS 515	GS 515 Energy / GS 515 Energy ⁺
Theoretical capacity [racks/h]	60	120/60/30	120/60/30	140/60/30	140/60/30
Width / system width [mm]	635/1410	635/1410	635/1410	735/1610	735/1610
Depth [mm]	749	749	749	749	749
Height [mm]					
– Hood closed	1420	1469	2145	1530	2235
– Hood open/ total height	1886	1932	2145	2050	2235
Input height [mm]	420 ± 5	420 ± 5	420 ± 5	440	440
Rack dimensions [mm]	500 x 500	500 x 500	500 x 500	500 x 500 540 x 500 500 x 600	500 x 500 540 x 500 500 x 600
Rinse water consumption per wash cycle* [l]	2 x 3.2	2 x 2.4	2 x 2.4	2 x 2.4	2 x 2.4
Tank temperature [°C]	60	60	60	60	60
Boiler temperature [°C]	85	85	85	85	85
Total connected load [kW]					
– Hot water connection 40-60 °C	2 x 8.9	2 x 9.5	–	2 x 9.6	–
– Cold water connection Up to 20 °C	2 x 14.9	2 x 15.5	2 x 12.5/2 x 9.5	2 x 15.6	2 x 12.6/2 x 9.6

Retrofitting with AirCon 500 is also possible for the GS 500 TwinSet Series.

* Under ideal conditions. Fresh water consumption is dependent on local conditions. Fine adjustments are made upon installation.



Dimensions

GS 501 / GS 502



GS 502 Energy / GS 502 Energy+

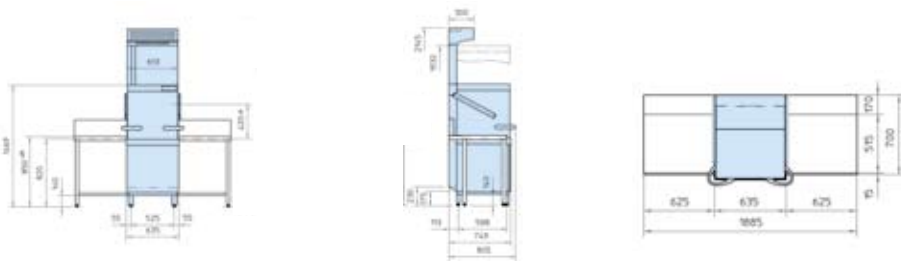

GS 501 TwinSet / GS 502 TwinSet

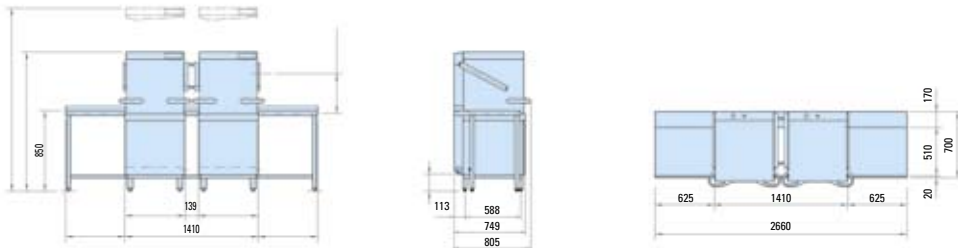

All additional dimensions same as GS 501 / GS 502

GS 515

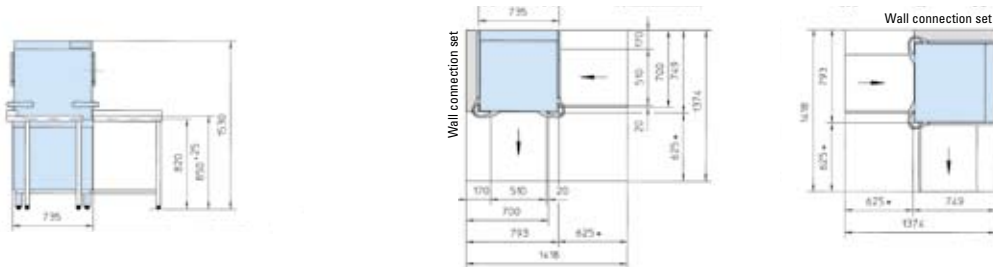

GS 515 Energy / GS 515 Energy+

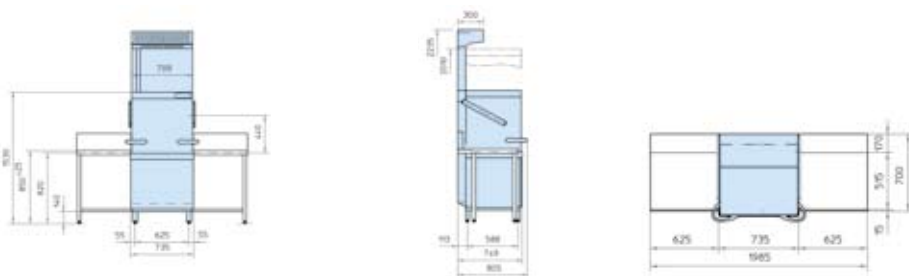

GS 515 TwinSet

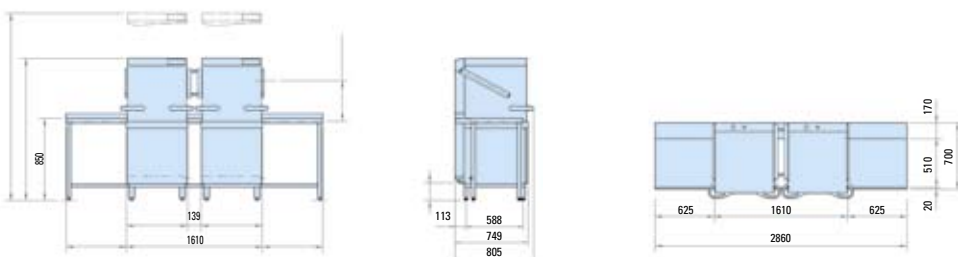

All additional dimensions same as GS 515

Winterhalter Gastronom GmbH
Commercial Dishwashing Systems

Tettninger Strasse 72
88074 Meckenbeuren · Germany
Telephone +49 (0) 75 42 4 02-0
Telefax +49 (0) 75 42 4 02-1 87

www.winterhalter.biz
info@winterhalter.biz

